

Care on Rail: Extendable Adaptable Sliders

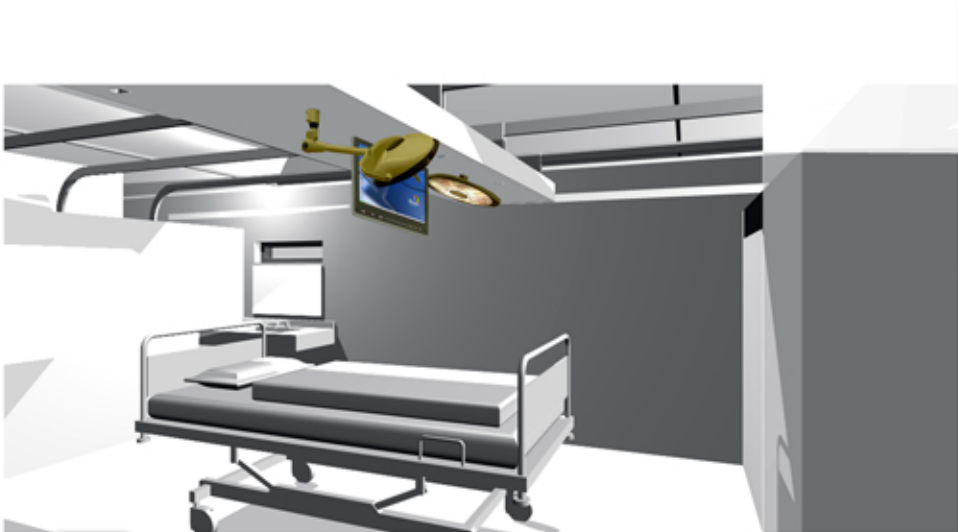

View at Entry of OR/ER

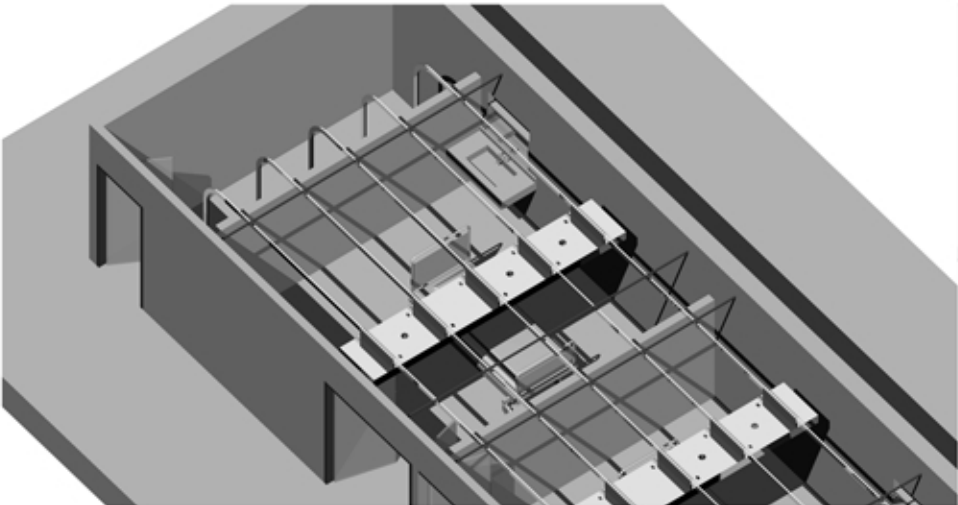

Axonometric View at Unit

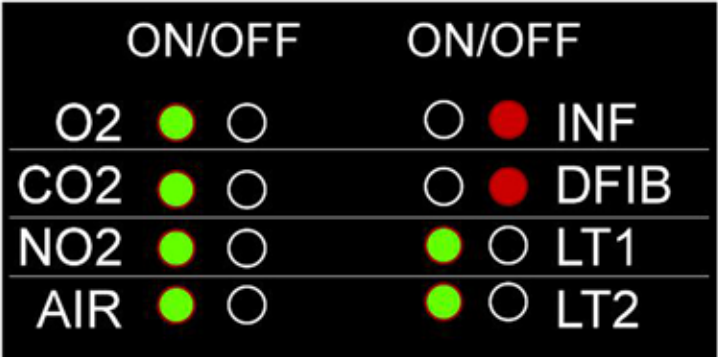

In our design of the slider we connect it to a rail mounted on the ceiling, which connects both equipment zones, and it can move back and forth between equipment zones.

In the Control Center, a technician can operate the sliders by choosing the ready slider (top most on a stack) and moves it forward on the rail until it reaches it's desired destination. Finally, another support mechanism descends it into the room, thereby freeing up the rail so other sliders can move freely. Furthermore, we designed the slider to include the most common set of instruments needed in the ER/OR. Each device can pull off the slider to be used and can be placed back into the slider via a recoil connector. The slider's height can be adjusted easily to accommodate the varying heights of the medical staff and thus eliminating extra stress added by trying to reach up to extract the needed tool.

Slider Design

